

Massachusetts Cultural Resource Information System

Scanned Record Cover Page

Inventory No:	SWN.147
Historic Name:	Marvel, A. T. House
Common Name:	
Address:	15 Mattapoisset Ave
City/Town:	Swansea
Village/Neighborhood:	South Swansea; Gardner's Neck;
Local No:	5;
Year Constructed:	1898
Architectural Style(s):	Shingle Style;
Architect(s):	Marvell, Edward I.;
Use(s):	Secondary Dwelling House;
Significance:	Architecture; Recreation;
Area(s):	SWN.F
Designation(s):	Nat'l Register District (02/16/1990); Nat'l Register MRA (02/16/1990);
Building Materials:	Roof: Asphalt Shingle; Wall: Wood Shingle;
Demolished	No



The Massachusetts Historical Commission (MHC) has converted this paper record to digital format as part of ongoing projects to scan records of the Inventory of Historic Assets of the Commonwealth and National Register of Historic Places nominations for Massachusetts. Efforts are ongoing and not all inventory or National Register records related to this resource may be available in digital format at this time.

The MACRIS database and scanned files are highly dynamic; new information is added daily and both database records and related scanned files may be updated as new information is incorporated into MHC files. Users should note that there may be a considerable lag time between the receipt of new or updated records by MHC and the appearance of related information in MACRIS. Users should also note that not all source materials for the MACRIS database are made available as scanned images. Users may consult the records, files and maps available in MHC's public research area at its offices at the State Archives Building, 220 Morrissey Boulevard, Boston, open M-F, 9-5.

Users of this digital material acknowledge that they have read and understood the MACRIS Information and Disclaimer (<http://mhc-macris.net/macrisdisclaimer.htm>)

Data available via the MACRIS web interface, and associated scanned files are for information purposes only. THE ACT OF CHECKING THIS DATABASE AND ASSOCIATED SCANNED FILES DOES NOT SUBSTITUTE FOR COMPLIANCE WITH APPLICABLE LOCAL, STATE OR FEDERAL LAWS AND REGULATIONS. IF YOU ARE REPRESENTING A DEVELOPER AND/OR A PROPOSED PROJECT THAT WILL REQUIRE A PERMIT, LICENSE OR FUNDING FROM ANY STATE OR FEDERAL AGENCY YOU MUST SUBMIT A PROJECT NOTIFICATION FORM TO MHC FOR MHC'S REVIEW AND COMMENT. You can obtain a copy of a PNF through the MHC web site (www.sec.state.ma.us/mhc) under the subject heading "MHC Forms."

Commonwealth of Massachusetts
Massachusetts Historical Commission
220 Morrissey Boulevard, Boston, Massachusetts 02125
www.sec.state.ma.us/mhc

This file was accessed on: Monday, June 27, 2022 at 8:00 PM

PL- S. SWAN GARD NR

NRDIS USGS -
NRMA 2/16/90
FALL

AREA E FORM NO. 147

1/2
1/2



Town SWANSEA

Address 15 Mattapoissett Avenue

Historic Name A. T. Marvel

Use: Present Summer Residence

Original Summer Residence

DESCRIPTION

Date 1898

Source Bristol County Registry of Deeds, Fall River, MA

Style SHINGLE

Architect Mr. Edward Marvel

Exterior Wall Fabric Shingle

Outbuildings two-car shingle garage

intersection(s).
Indicate north Lee's River

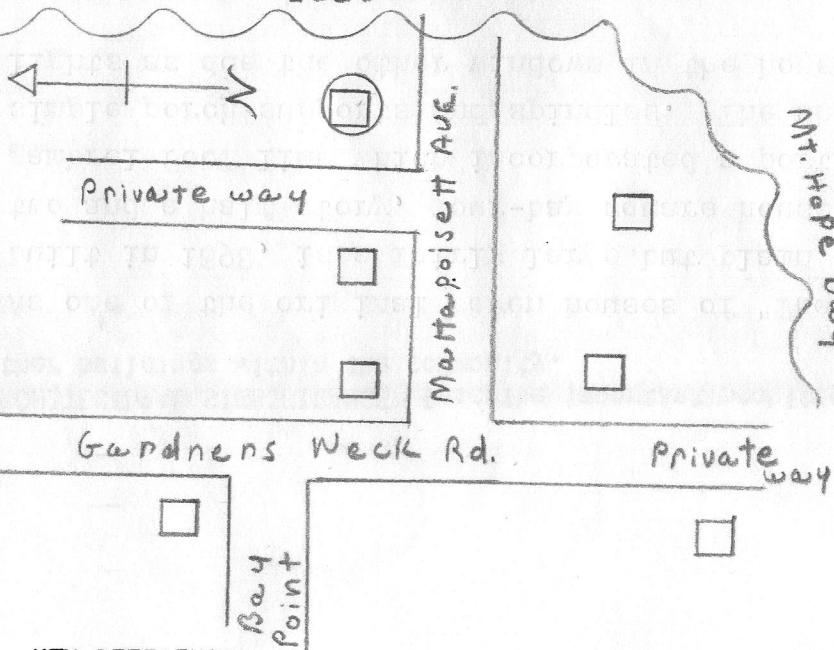

Major Alterations (with dates) Back stairs

Moved to east side c. 1950

Condition Well preserved

Moved No Date

Acreage One acre or less

Setting Overlooking Lee's River and

New England Electric on an open and treeless lot.

Recorded by Kay Flynn/E. A. Waring
April, 1978

Organization Swansea Historical Commission

Date January, 1986

UTM REFERENCE

USGS QUADRANGLE Fall River, Mass. RI 1967-79

SCALE

NATIONAL REGISTER CRITERIA STATEMENT (if applicable)

ARCHITECTURAL SIGNIFICANCE Describe important architectural features and evaluate in terms of other buildings within the community.

As one of the original seven houses of "The Colony," No. 15 Mattapoissett Avenue built in 1898, is a fairly large but plain dwelling in the shingle style. This two and a half story, four-bay square house is distinguished by its encompassing gambrel roof line which incorporated a portion of the three-sided porch with simple porch supports and spindles. The shed triple dormer has two over two lights as do the other windows in the house.

HISTORICAL SIGNIFICANCE Explain the role owners played in local or state history and how the building relates to the development of the community.

At the turn of the century the point of land at the end of Gardner's Neck facing Lee's River and Mt. Hope Bay was ideal for summer recreational activities. Seven houses including No. 15 Mattapoissett Avenue, were built in this area between 1896 and 1902 for Fall River families who came to spend the summer in Swansea. This group of houses was known as "The Colony." "The Colony" is describe in area _____ form.

BIBLIOGRAPHY and/or REFERENCES

Bristol County Registry of Deeds, Fall River, MA
Deed from Robert A. Wilcox and Eric Borden to Annie C. Marvel
March 1, 1898 - Book 56, page 438

FORM B - BUILDING

MASSACHUSETTS HISTORICAL COMMISSION
Office of the Secretary, State House, Boston

In Area no. A	Form no. 147
------------------	-----------------



1. Town SWANSEA
Address 15 Mattapoissett Avenue
Name _____
Present use Summer residence
Present owner Louise T. Cottrell

3. Description:
Date 1898
Source Bristol County Registry
of Deeds, Fall River, Ma.
Style SHINGLE

Architect Mr. Edward Marvell
Exterior wall fabric Shingles
Outbuildings (describe) Garage
Other features Porch on three sides of house

Altered Back stairs Date c. 1950
moved to east side
Moved _____ Date _____

5. Lot size:
One acre or less Over one acre _____
Approximate frontage 100'
Approximate distance of building from street
10'

6. Recorded by Mrs. Ellis A. Waring
Organization Swansea Historical Society
Date April 25, 1978

4. Map. Draw sketch of building location in relation to nearest cross streets and other buildings. Indicate north.

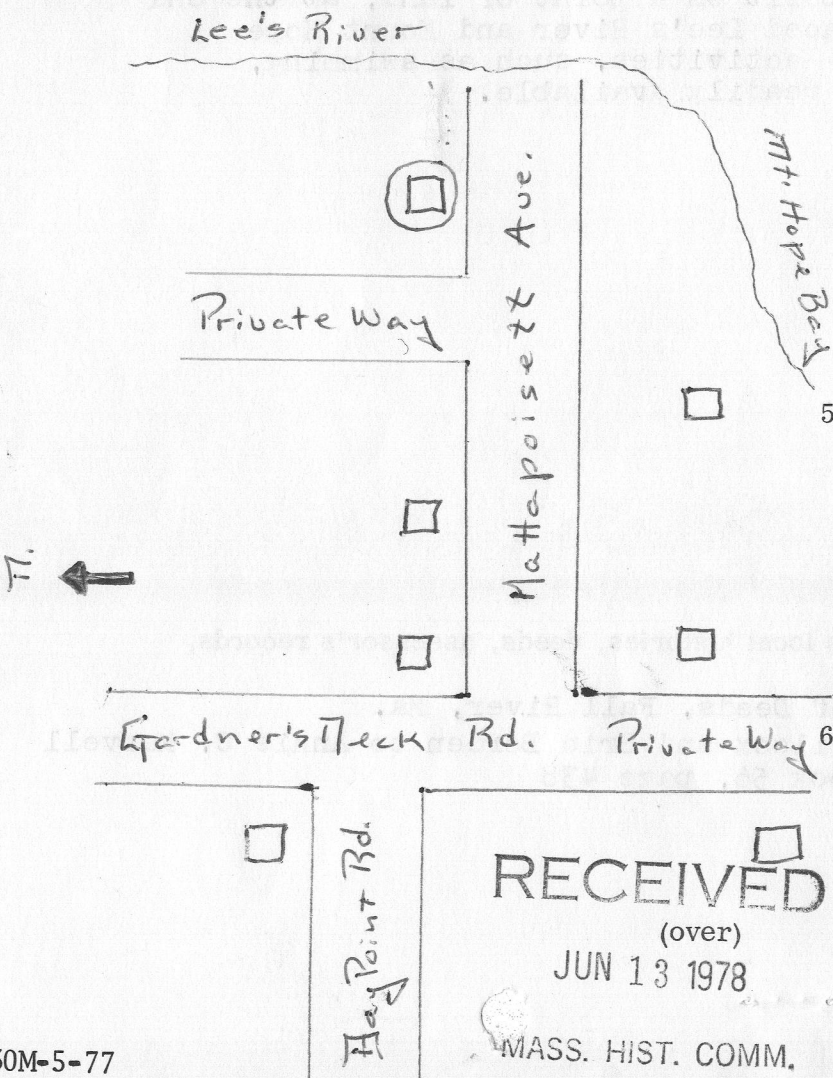

7. Original owner (if known) Annie C. Marvell
 Original use Summer residence
 Subsequent uses (if any) and dates Same until present

8. Themes (check as many as applicable)

Aboriginal	<u> </u>	Conservation	<u> </u>	Recreation	<u> X </u>
Agricultural	<u> </u>	Education	<u> </u>	Religion	<u> </u>
Architectural	<u> ✓ </u>	Exploration/ settlement	<u> </u>	Science/ invention	<u> </u>
The Arts	<u> </u>	Industry	<u> </u>	Social/ humanitarian	<u> </u>
Commerce	<u> </u>	Military	<u> </u>	Transportation	<u> </u>
Communication	<u> </u>	Political	<u> </u>		
Community development	<u> X </u>				

9. Historical significance (include explanation of themes checked above)

Community development:
 This house was one of seven built between 1896 and 1902 for Fall River families who came to spend the summer in Swansea. The group of houses was known as "The Colony" and is described as an Area on another sheet.

Recreation:
 Since these houses were built on a point of land, at the end of Gardner's Neck, and faced Lee's River and Mount Hope Bay, summer recreational activities, such as swimming, boating and fishing were readily available.

10. Bibliography and/or references (such as local histories, deeds, assessor's records, early maps, etc.)
 Bristol County Registry of Deeds, Fall River, Ma.
 Deed from Robert A. Wilcox and Eric Borden to Annie C. Marvell
 March 1, 1898 - Book 56, page 438