

# Massachusetts Cultural Resource Information System

## Scanned Record Cover Page

<b>Inventory No:</b>	SWN.2
<b>Historic Name:</b>	Daggett Place, The
<b>Common Name:</b>	
<b>Address:</b>	22-24 Barneyville Rd
<b>City/Town:</b>	Swansea
<b>Village/Neighborhood:</b>	North Swansea;
<b>Local No:</b>	63;
<b>Year Constructed:</b>	R 1772
<b>Architectural Style(s):</b>	Georgian;
<b>Use(s):</b>	Multiple Family Dwelling House;
<b>Significance:</b>	Architecture; Maritime History;
<b>Area(s):</b>	SWN.A
<b>Designation(s):</b>	Nat'l Register District (02/16/1990); Nat'l Register MRA (02/16/1990);
<b>Building Materials:</b>	Roof: Asphalt Shingle; Wall: Wood Clapboard; Foundation: Granite;
<b>Demolished</b>	No



The Massachusetts Historical Commission (MHC) has converted this paper record to digital format as part of ongoing projects to scan records of the Inventory of Historic Assets of the Commonwealth and National Register of Historic Places nominations for Massachusetts. Efforts are ongoing and not all inventory or National Register records related to this resource may be available in digital format at this time.

The MACRIS database and scanned files are highly dynamic; new information is added daily and both database records and related scanned files may be updated as new information is incorporated into MHC files. Users should note that there may be a considerable lag time between the receipt of new or updated records by MHC and the appearance of related information in MACRIS. Users should also note that not all source materials for the MACRIS database are made available as scanned images. Users may consult the records, files and maps available in MHC's public research area at its offices at the State Archives Building, 220 Morrissey Boulevard, Boston, open M-F, 9-5.

Users of this digital material acknowledge that they have read and understood the MACRIS Information and Disclaimer (<http://mhc-macris.net/macrisdisclaimer.htm>)

Data available via the MACRIS web interface, and associated scanned files are for information purposes only. THE ACT OF CHECKING THIS DATABASE AND ASSOCIATED SCANNED FILES DOES NOT SUBSTITUTE FOR COMPLIANCE WITH APPLICABLE LOCAL, STATE OR FEDERAL LAWS AND REGULATIONS. IF YOU ARE REPRESENTING A DEVELOPER AND/OR A PROPOSED PROJECT THAT WILL REQUIRE A PERMIT, LICENSE OR FUNDING FROM ANY STATE OR FEDERAL AGENCY YOU MUST SUBMIT A PROJECT NOTIFICATION FORM TO MHC FOR MHC'S REVIEW AND COMMENT. You can obtain a copy of a PNF through the MHC web site ([www.sec.state.ma.us/mhc](http://www.sec.state.ma.us/mhc)) under the subject heading "MHC Forms."

Commonwealth of Massachusetts  
Massachusetts Historical Commission  
220 Morrissey Boulevard, Boston, Massachusetts 02125  
[www.sec.state.ma.us/mhc](http://www.sec.state.ma.us/mhc)

This file was accessed on: Monday, June 27, 2022 at 7:44 PM



NRmRA > 2/16/90  
NRDIS

NR

USGS - E. PROV  
PL - N. SWAN

AREA	FORM NO.
A	2

3 NC

Town SWANSEA

Address 22 & 24 Barneyville Road

Historic Name The Daggett Place

Use: Present Residential

Original Residence

DESCRIPTION

Date 1771-1774

Source Tradesman's bill dated 5/5/1774

Style 1 story New England Cape Cod

Architect \_\_\_\_\_

Exterior Wall Fabric clapboard

Outbuildings Vict. wash house

Major Alterations (with dates) \_\_\_\_\_

shed dormer - 1938

Condition \_\_\_\_\_

Moved No Date \_\_\_\_\_

Acreege One acre

Setting Located near the Palmer River, this property abutts beattifull field & marshes to the river. 20th century

landscaping has not altered the ambience of this home, simple in detail. Recorded by Kim Valente/M. Gowdey '78

Organization Swansea Historical Commission

Date March, 1986

between inventoried property and nearest intersection(s).  
Indicate north

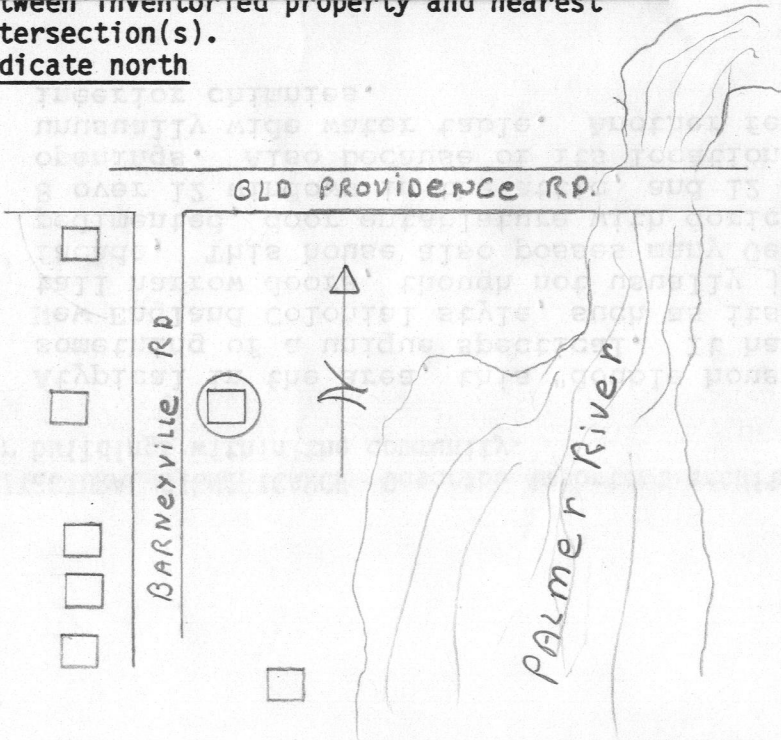

UTM REFERENCE \_\_\_\_\_

USGS QUADRANGLE East Providence-RI-MA 1971-79

SCALE \_\_\_\_\_

## NATIONAL REGISTER CRITERIA STATEMENT (if applicable)

**ARCHITECTURAL SIGNIFICANCE** Describe important architectural features and evaluate in terms of other buildings within the community.

Atypical in the area, this "double house, " is what would be known as something of a unique spectacle. It has many features, known to the New England Colonial style, such as its high pitched - roof, one - story, tall narrow doors, though not usually joined, but separated on ends of the facade. This house also possesses many Georgian details, such as its unpedimented, door entablature with doric columns, and transom light above 8 over 12 windows in the attic, and 12 over 12 windows at all other window openings. Also because of its location near the river, the house has an unusually wide water table. Another feature of the house are paired interior chimneys.

**HISTORICAL SIGNIFICANCE** Explain the role owners played in local or state history and how the building relates to the development of the community.

Mason Barney built for speculation. Started in 1771, the shipyard was the MA IN industry in North Swansea (locally known as "Bungtown") and flourished until the time of the Civil War. At this time Mason Barney had three ships being built, so was forced into bankruptcy in 1861. Barney's shipyard spread over more than 5 acres of land beside the Palmer River. By 1850 the yard employed more than 200 workers in Swansea.. a town which at that time contained some 280 families.

Around the shipyard grew "Bungtown" or Barneyville as it came to be called, which included the shipyard, an iron foundry, a store, post office, brickyard, and a small knot of houses. "Spuire" Barney owned practically all of it. Mason Barney's ships were known and recognized in ports all over the world.

King Philip's War started in this area in 1664. A marker has been placed on Old Providence Road at the junction of Barneyville Road.

Mary A. Gowdey lives in the house at present, and states that Mason Barney himself had lived in that house for several years.

**BIBLIOGRAPHY and/or REFERENCES**

- Barney, Mason Genealogies.. R.I. Historical Society. "Ships Documents of R.I." R.I. Historical Society;  
 Records of Deeds, Fall River, Ma.  
 100th Anniversary of Warren R.I. 1947 by Henry J. Peck  
 "Who Was Mason Barney" by Gail Eastwood from East Bay Window 5/21-22, 1975

FORM B - BUILDING

MASSACHUSETTS HISTORICAL COMMISSION  
Office of the Secretary, State House, Boston

In Area no.	Form no.
	632



1. Town North Swansea, Massachusetts  
 Address 22 & 24 Barneyville Road  
 Name Known as "The Daggett Place"  
 Present use Residential (in Historic District)  
 Present owner Mary A Gowdey

3. Description:  
 Date 1771-1774...Shipyard established 1771  
 Source Tradesman's bill dated 5/5/1774 when dormer was added in 1938  
 Style 1 1/2 gable, 2 chimneys, stone foundation  
 Architect Entrance: Double flat-head, Doric pilasters  
 Exterior wall fabric wood  
 Outbuildings (describe) Vict. wash house, wood  
 Other features Windows double-hung upstairs 8/12, 12/12 down. Field/marsh leading to Palmer River, excellent shrubs, flowers etc.

#22-24 Barneyville Rd 02777 (Duplex)  
 No. Swansea, Ma.

4. Map. Draw sketch of building location in relation to nearest cross streets and other buildings. Indicate north.

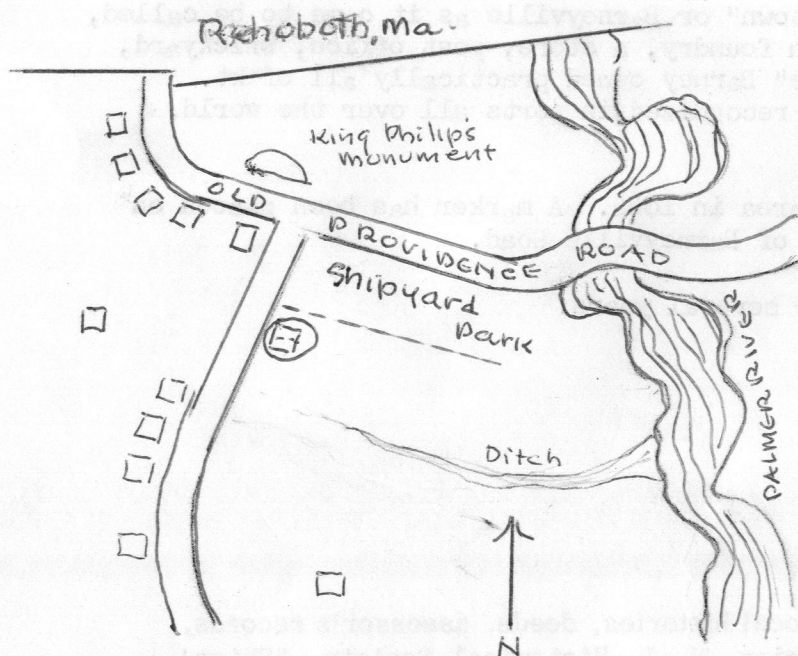

Altered Shed Dormer(rear) Date 1938  
 Moved \_\_\_\_\_ Date \_\_\_\_\_  
 5. Lot size: 155' x 287'  
One acre ~~bt/16/8/8~~ Over one acre \_\_\_\_\_  
 Approximate frontage 155'  
 Approximate distance of building from street 6'

RECEIVED

OCT 17 1979

MASS. HIST. COMM.

6. Recorded by Mary A Gowdey  
 Organization Swansea Hist. Society & Cultural & Historical Assesets of Swan. Commission  
 Date 21 January, 1978

(over)

7. Original owner (if known) Built by a shipwright, possibly a Daggett

Original use Built by and for shipwrights for their families

Subsequent uses (if any) and dates Always residential

8. Themes (check as many as applicable)

- |                       |       |                            |              |                         |       |
|-----------------------|-------|----------------------------|--------------|-------------------------|-------|
| Aboriginal            | _____ | Conservation               | _____        | Recreation              | _____ |
| Agricultural          | _____ | Education                  | _____        | Religion                | _____ |
| Architectural         | _____ | Exploration/<br>settlement | _____        | Science/<br>invention   | _____ |
| The Arts              | _____ | Industry                   | <u>  x  </u> | Social/<br>humanitarian | _____ |
| Commerce              | _____ | Military                   | <u>  x  </u> | Transportation          | _____ |
| Communication         | _____ | Political                  | _____        |                         |       |
| Community development | _____ |                            |              |                         |       |

9. Historical significance (include explanation of themes checked above)

Mason Barney built for speculation. Started in 1771, the shipyard was the MA IN industry in North Swansea (locally known as "Bungtown") and flourished until the time of the Civil War. At this time Mason Barney had three ships being built, so was forced into bankruptcy in 1861. Barney's shipyard spread over more than 5 acres of land beside the Palmer River. By 1850 the yard employed more than 200 workers in Swansea..a town which at that time contained some 280 families.

Around the shipyard grew "Bungtown" or Barneyville as it came to be called, which included the shipyard, an iron foundry, a store, post office, brickyard, and a small knot of houses. "Squire" Barney owned practically all of kt. Mason Barney's ships were known and recognized in ports all over the world.\*

King Philip's War started in this area in 1664. A marker has been placed on Old Providence Road at the junction of Barneyville Road.

\*Mason Barney lived in my house for several years.

10. Bibliography and/or references (such as local histories, deeds, assessor's records, early maps, etc.) Barney Mason Geneologies..R. I. Historical Society. "Ships' Documents of R I" R I Hist. Society; Swansea Historical Society; Records of Deeds, Fall River, Mass; "a00th Anniversary of Warren R I 1947" by Henry J Peck "Who Was Mason Barney" by Gail Eastwood from "East Bay Window" 5/21-22, 1975